



IPIC 2023

9th International
Physical Internet Conference

June 13-15, 2023
Athens, Greece



Enhancing Circular Logistics of Unit Loads by Leveraging Physical Internet Modularization and Consolidation Principles

Authors:

Jorge Garcia Zamalloa^{1&2}

Ali V. Barenji^{1&2}

Benoit Montreuil^{1&2}

1. Physical Internet Center, Supply Chain & Logistics Institute, Georgia Institute of Technology, Atlanta, GA, USA
2. School of Industrial & Systems Engineering, Georgia Institute of Technology, Atlanta, GA, USA

June 13th, 2023

13-15 JUNE 2023 Athens, Greece
www.pi.events/IPIC2023

alice | Alliance for
Logistics Innovation
through Collaboration
in Europe



Expanding the logistics Scope

Table of Contents



01

Industry Context

Flow of items across a Supply Chain
RTI Operational Workflow inside Facility
Main Challenges in the Industry



02

Proposed Framework and Simulation Design



03

Simulation Implementation

Implementation of Model with Maturity Level 1
Implementation of Model with Maturity Level 2
Implementation of Model with Maturity Level 3



04

Simulation Results



05

Conclusions

Flow of items across a Supply Chain

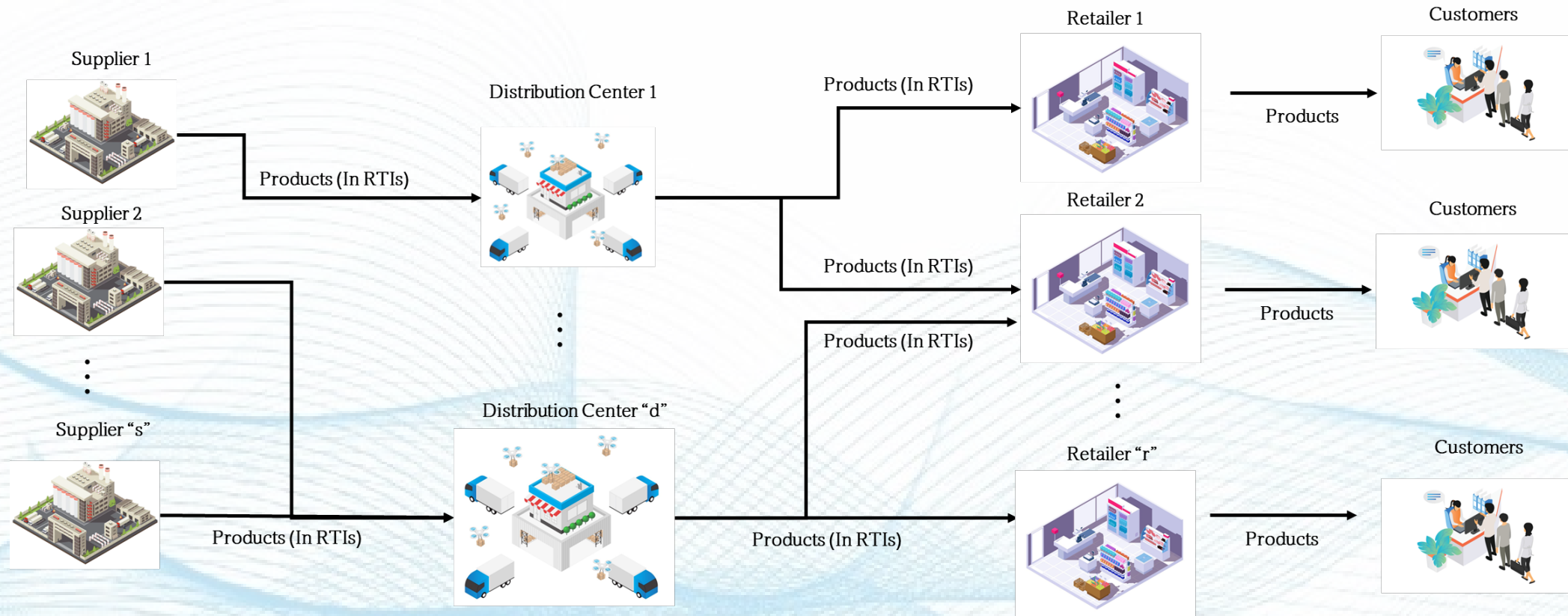

Flow of items across a Supply Chain

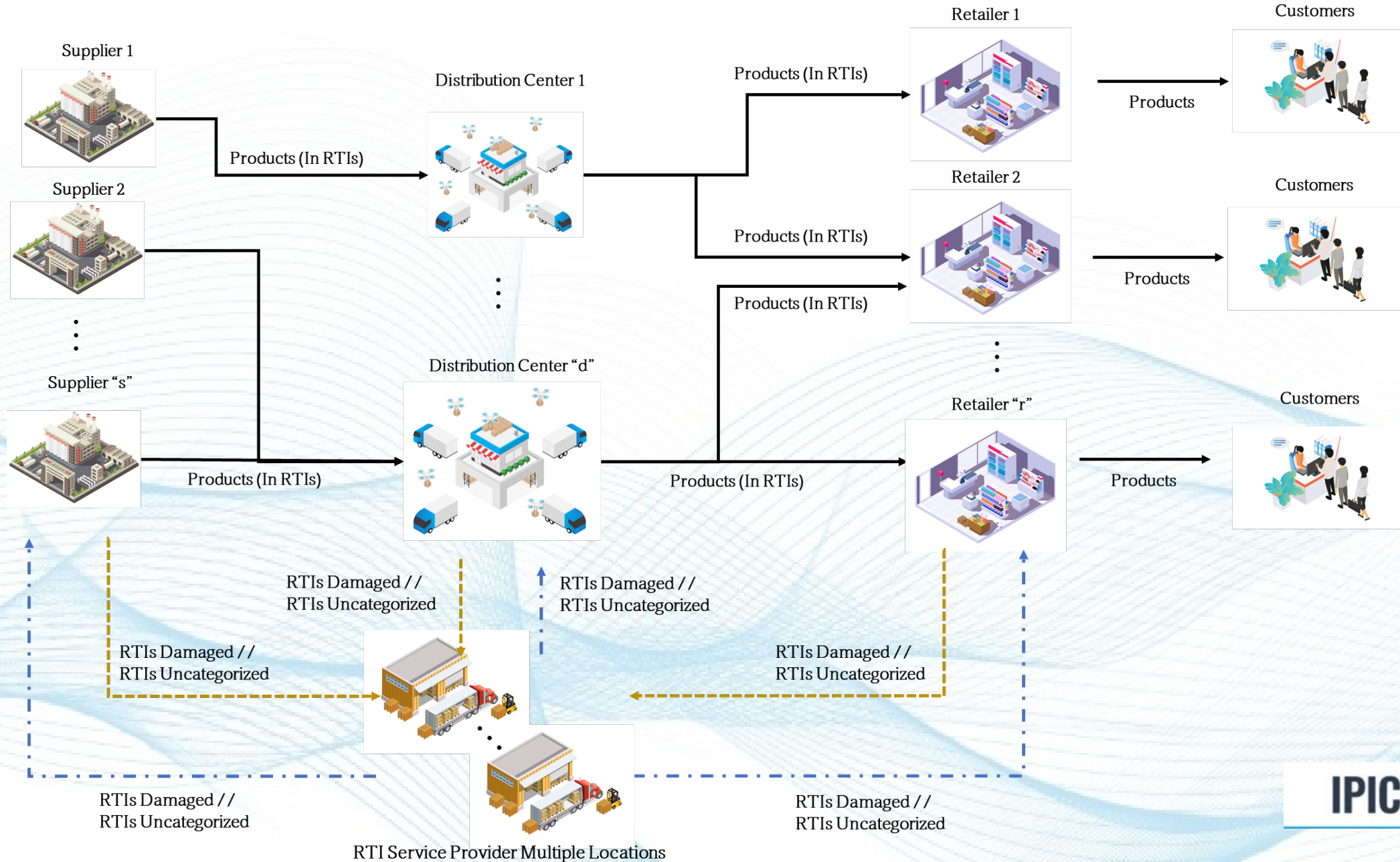

Scope of the Study Case

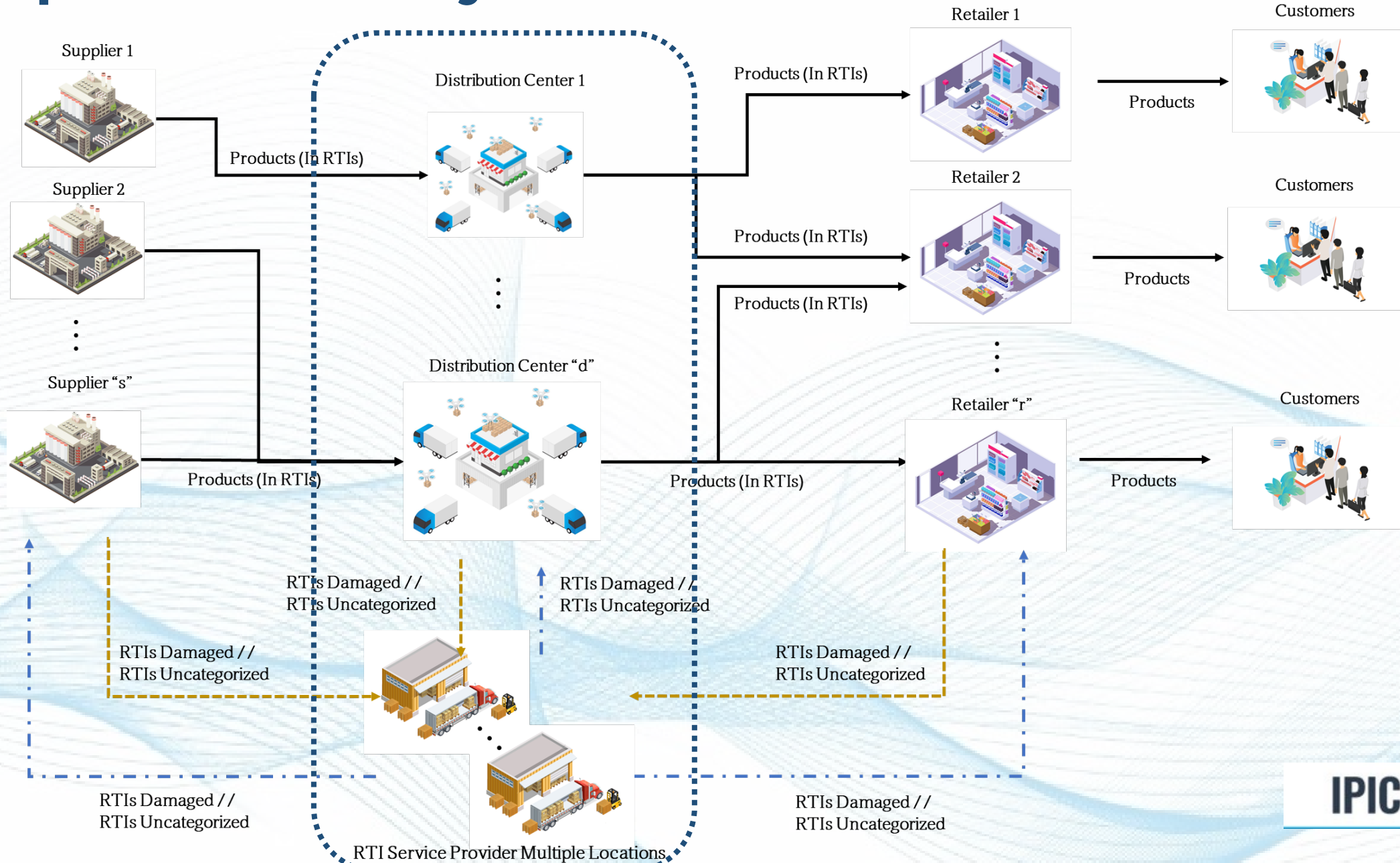

RTI Operational Workflow inside Facility

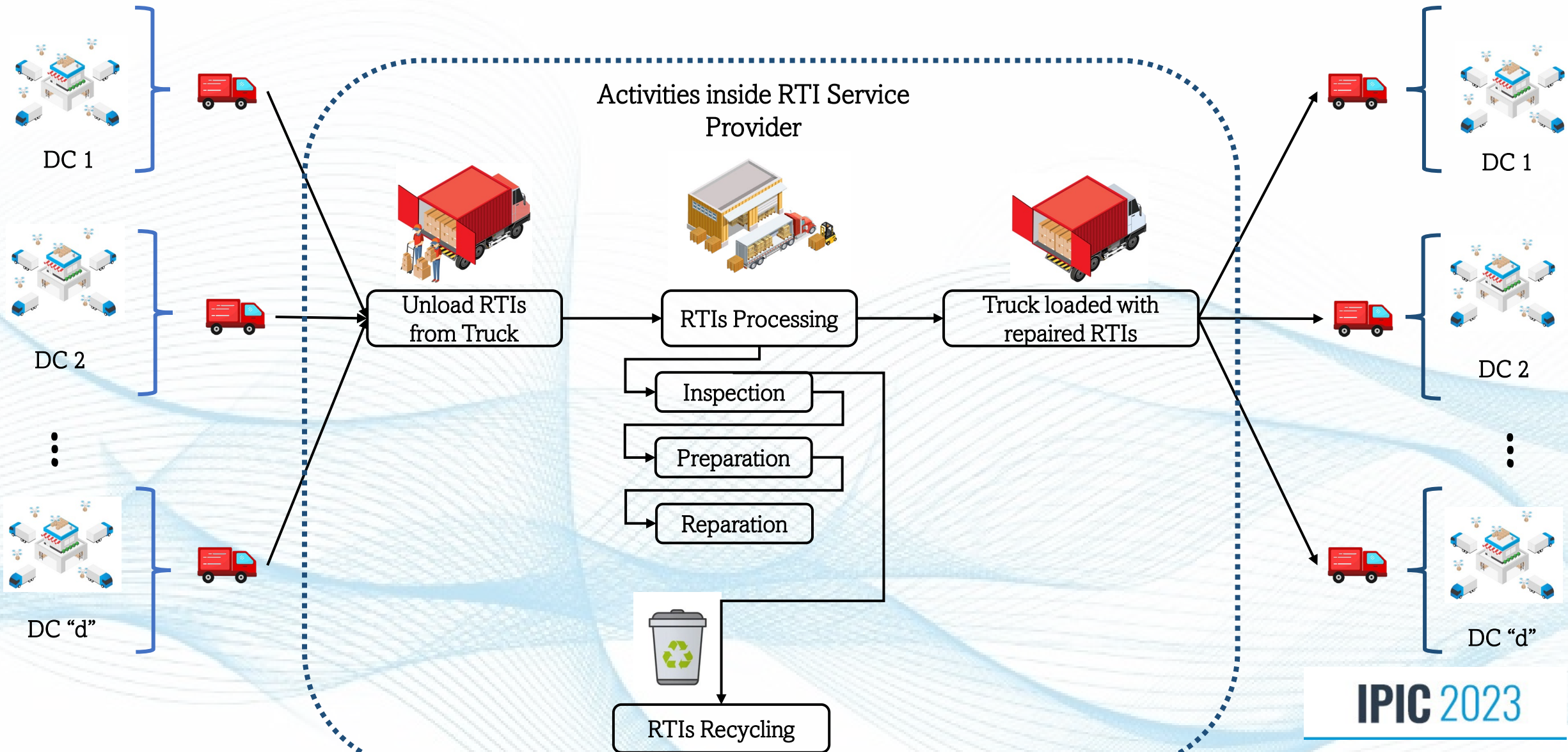

Main Challenges

1

Demand Fluctuation of RTIs

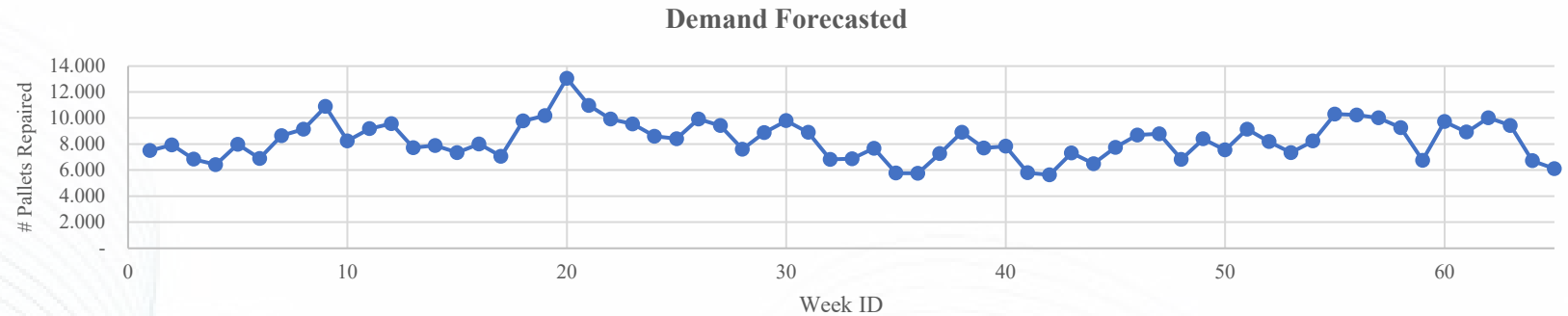

2

Suboptimal unloading/loading practices

- All RTIs are unloaded and complete the process.
- Shipment delays despite the availability of material.



3

Inefficiencies in time processes

- Workflows not designed to minimize distance walked.
- Workstations do not have standard set of tools
- Inventory levels hide inefficiencies in the productive capacity



Sources:

(1) From: <https://blog.unicarriereurope.com/material-handling-blog/loading-unloading-lorry-warehouse-pallet-trucks-or-counterbalance-forklifts-advice-analysis>

(2) From: <https://www.shutterstock.com/es/search/inefficient>

IPIC 2023

Proposed Framework Solution

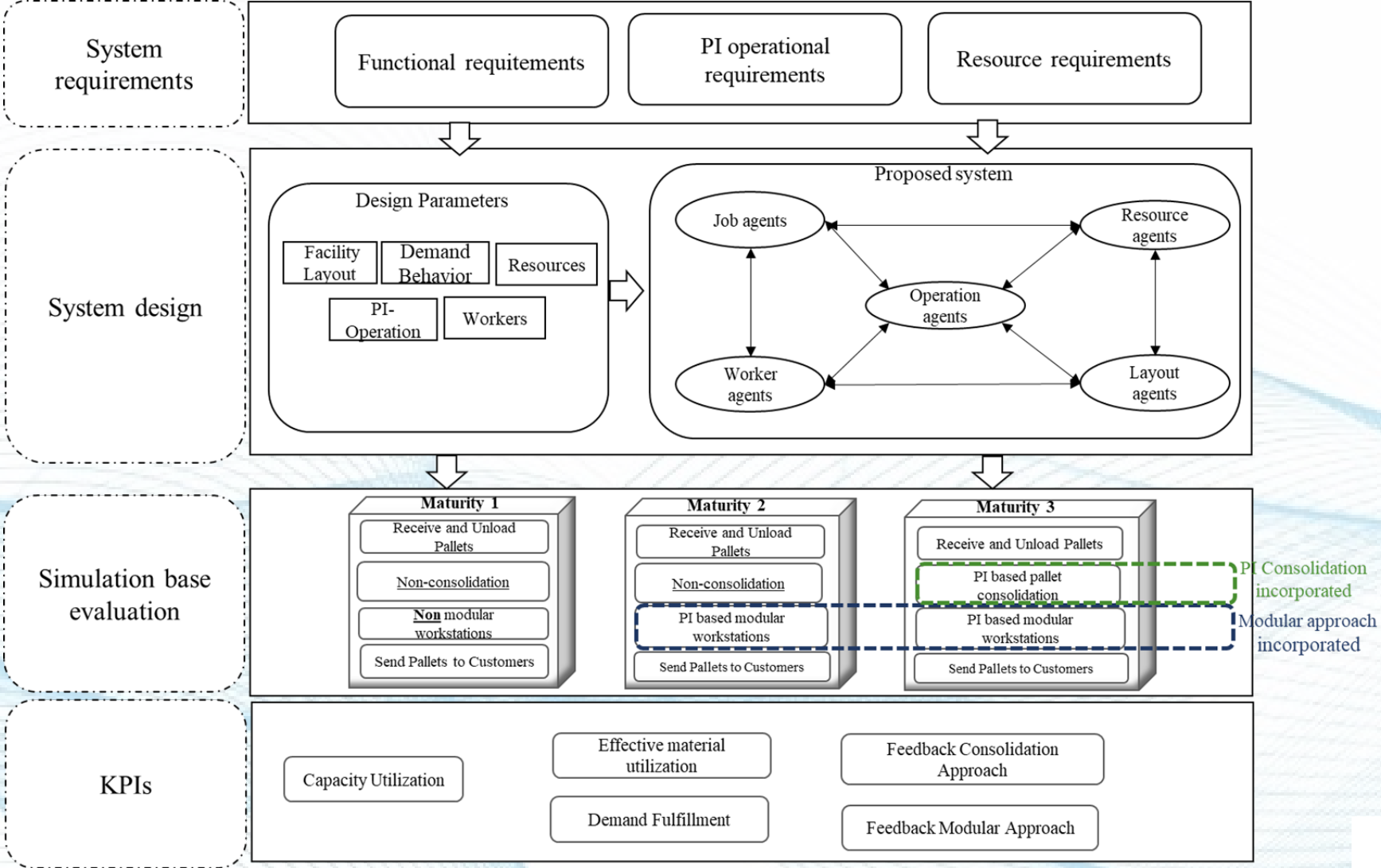

PI Concepts Involved in the Solution

Modularity

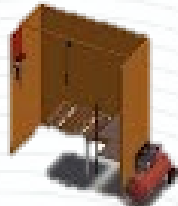

- Independent and self-contained units
- Adaptable to multiple locations
- Flexible to operating conditions
- Ergonomic

Consolidation



PI Concepts Involved in the Solution

Modularity

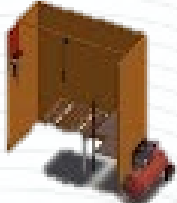

- Independent and self-contained units
- Adaptable to multiple locations
- Flexible to operating conditions
- Ergonomic

Consolidation

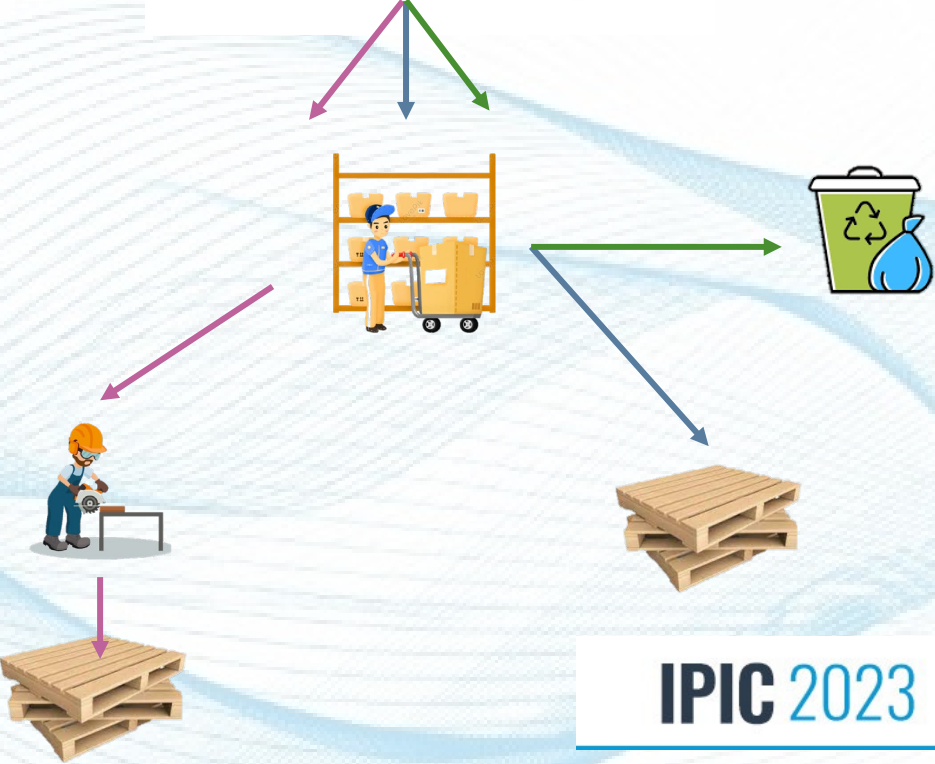

Maturity Level 1

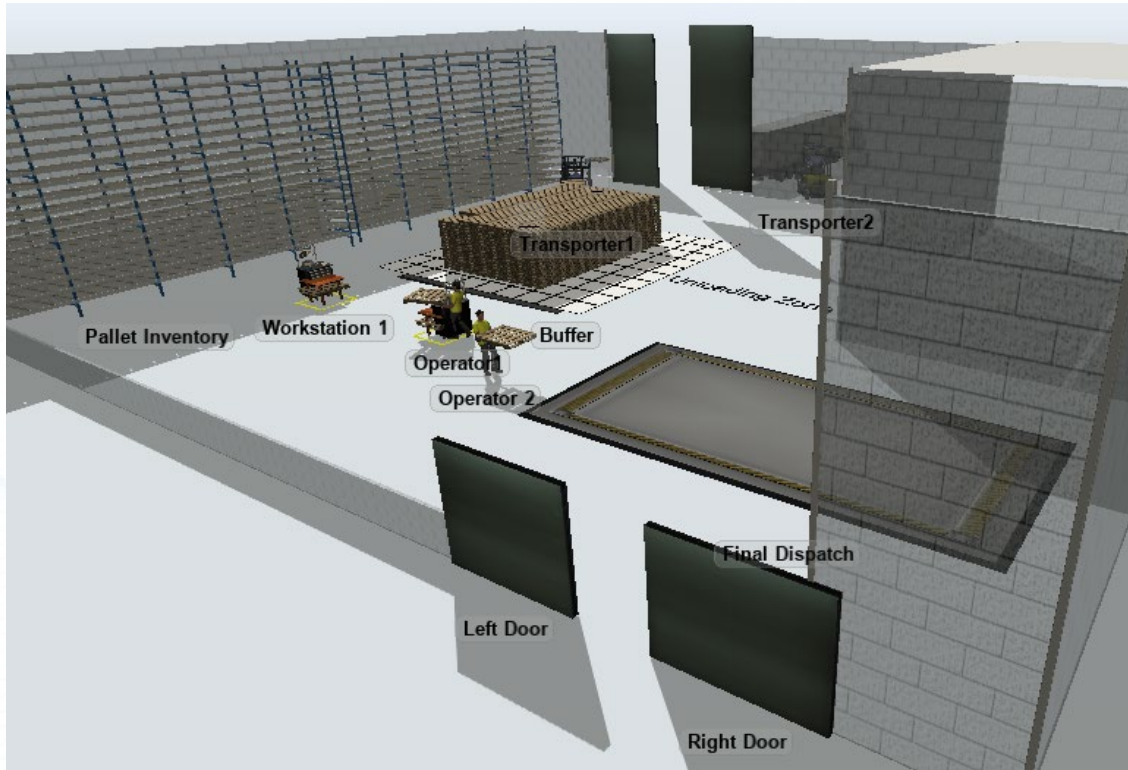

- Fix Capacity Production through time horizon.
- All RTIs will complete the whole process.
- Time spend in workstation is not under control.

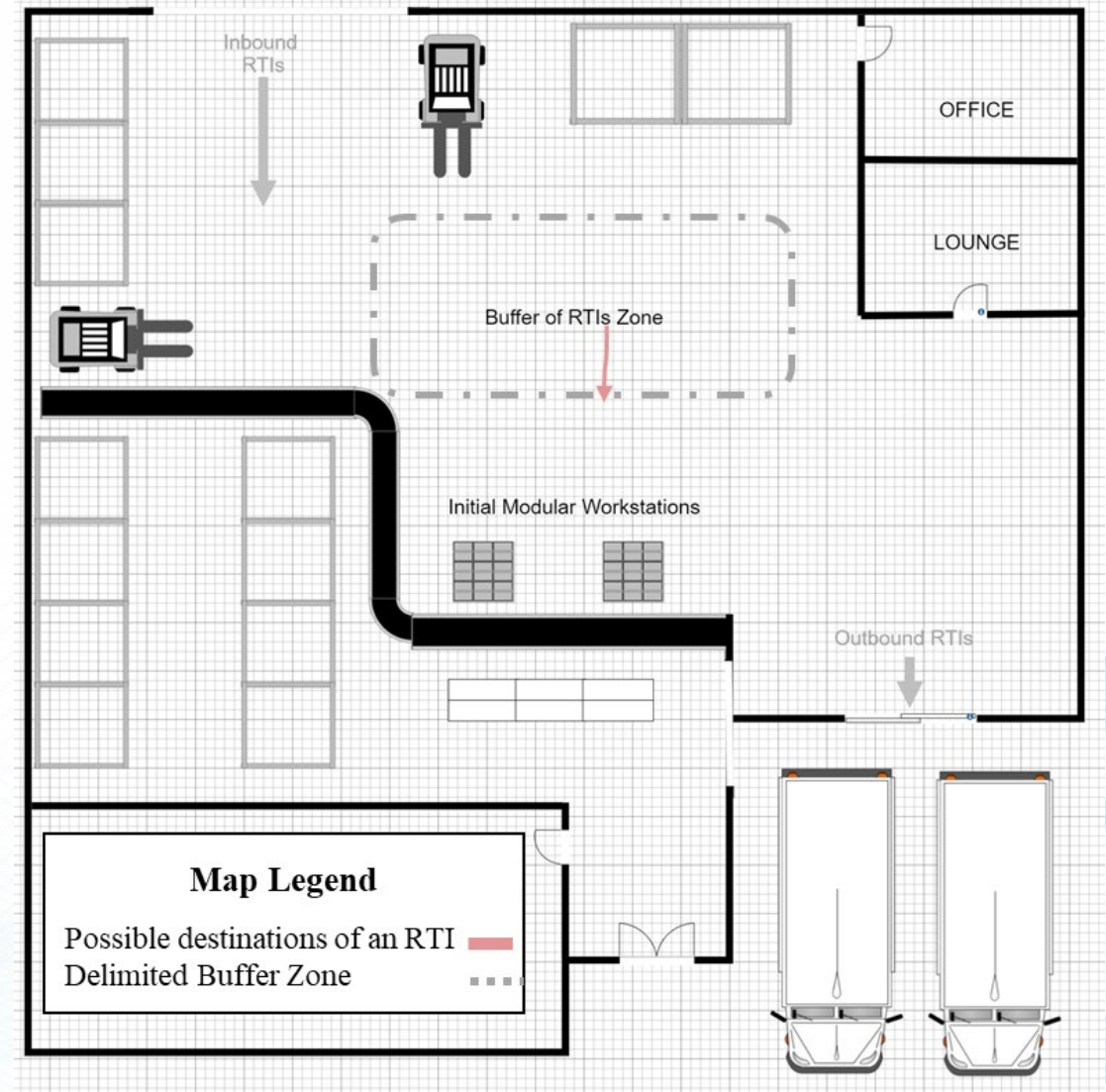

Maturity Level 2

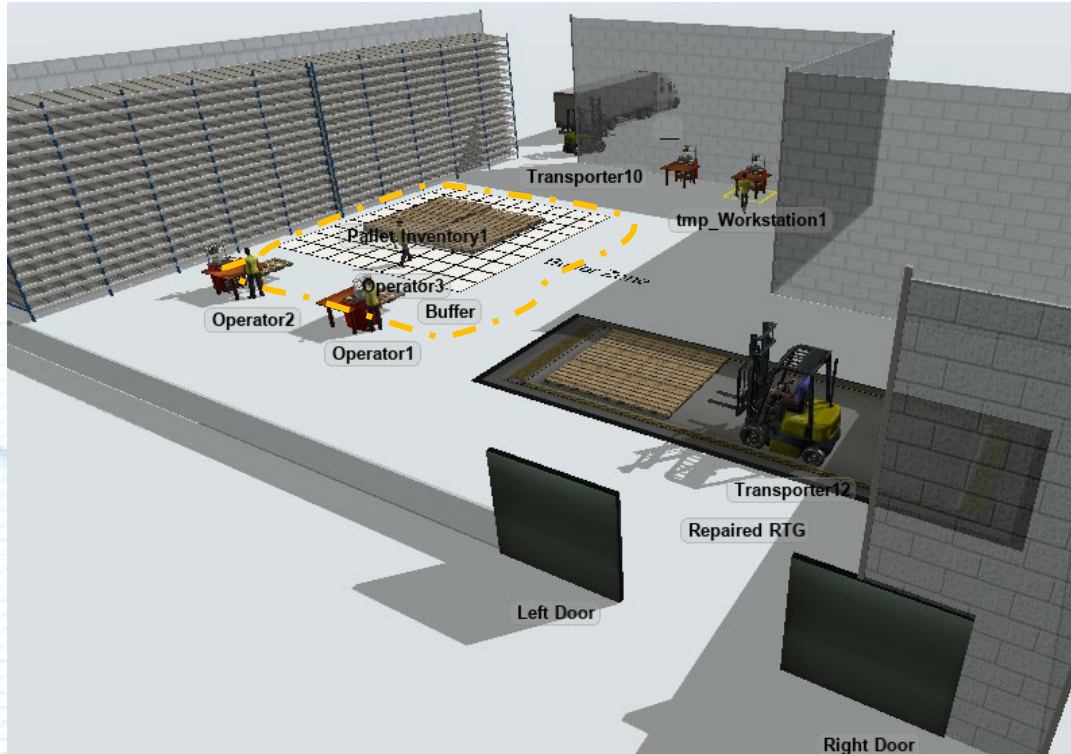

- Flexible Capacity Production through time horizon.
- All RTIs will complete the whole process.
- Time spend in workstation is under control.

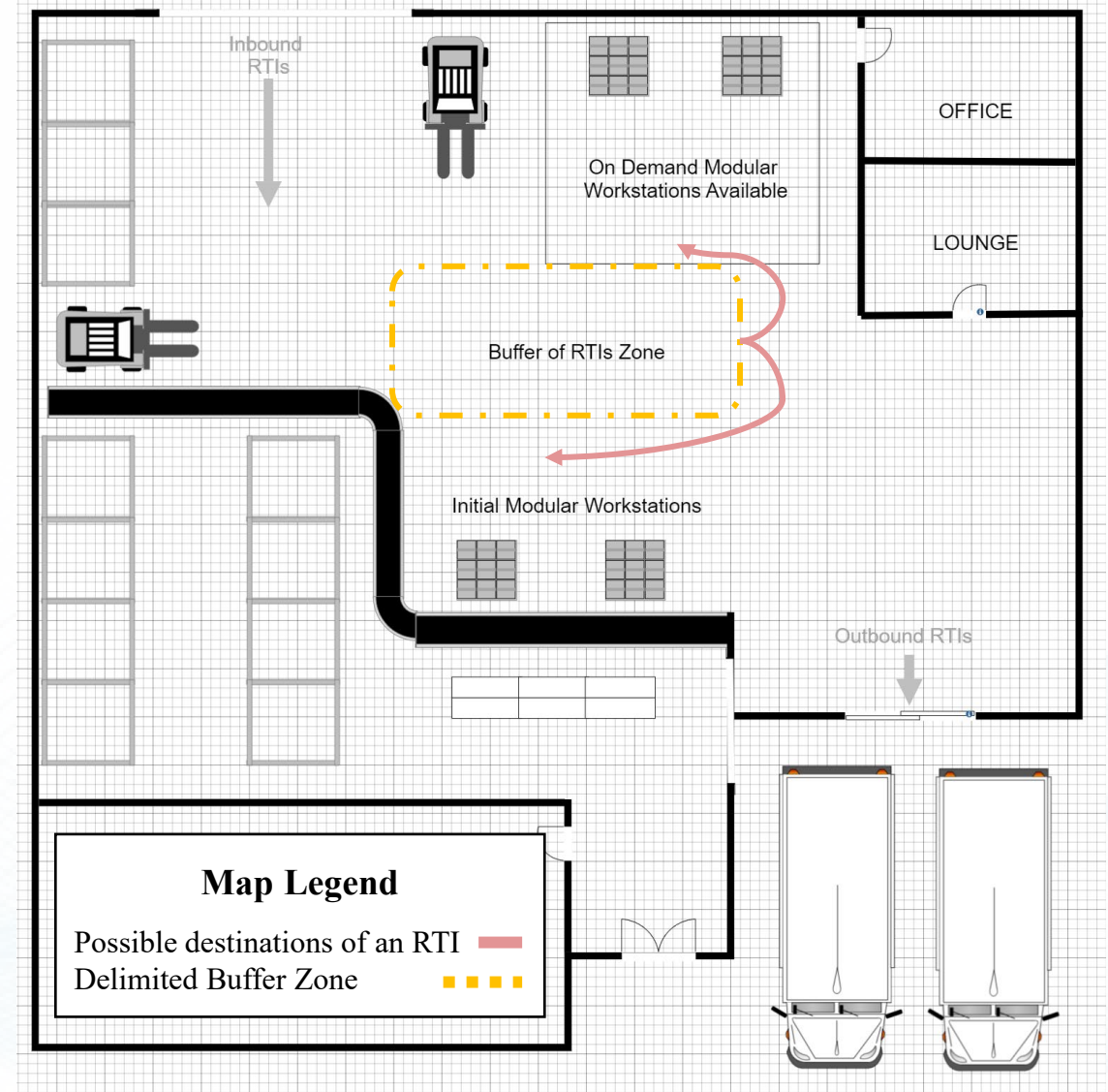

Maturity Level 3

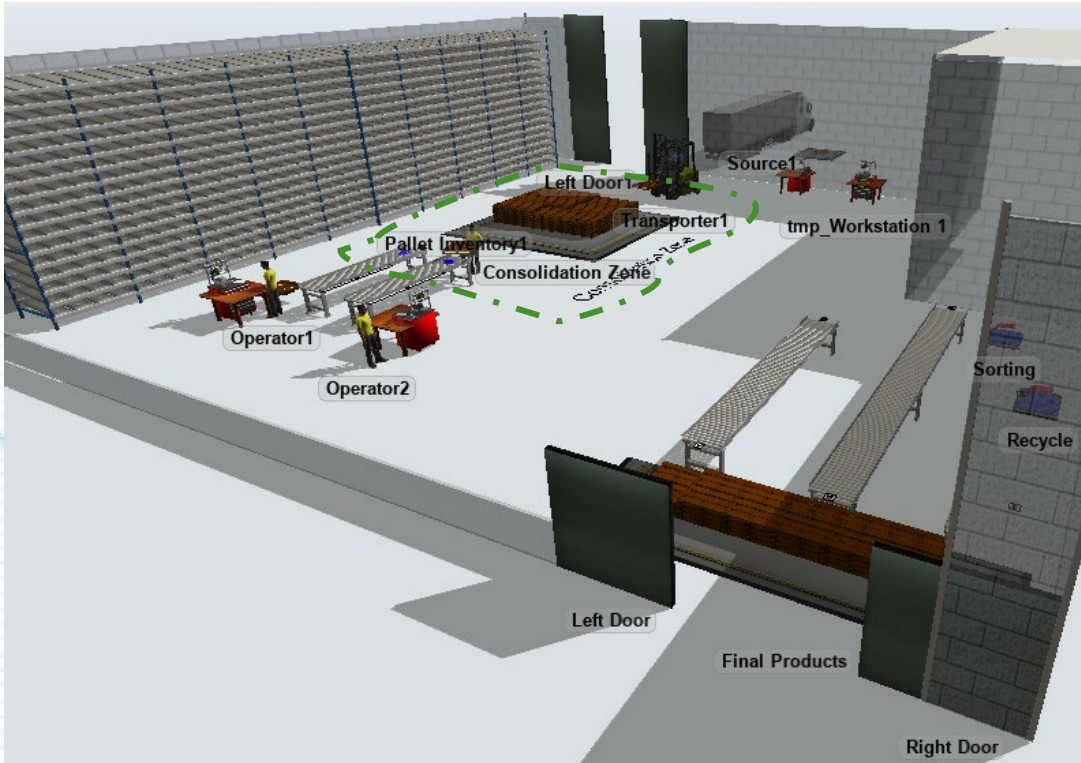

- Flexible Capacity Production through time horizon.
- Cargo consolidation is integrated into the operation.
- Time spend in workstation is under control.

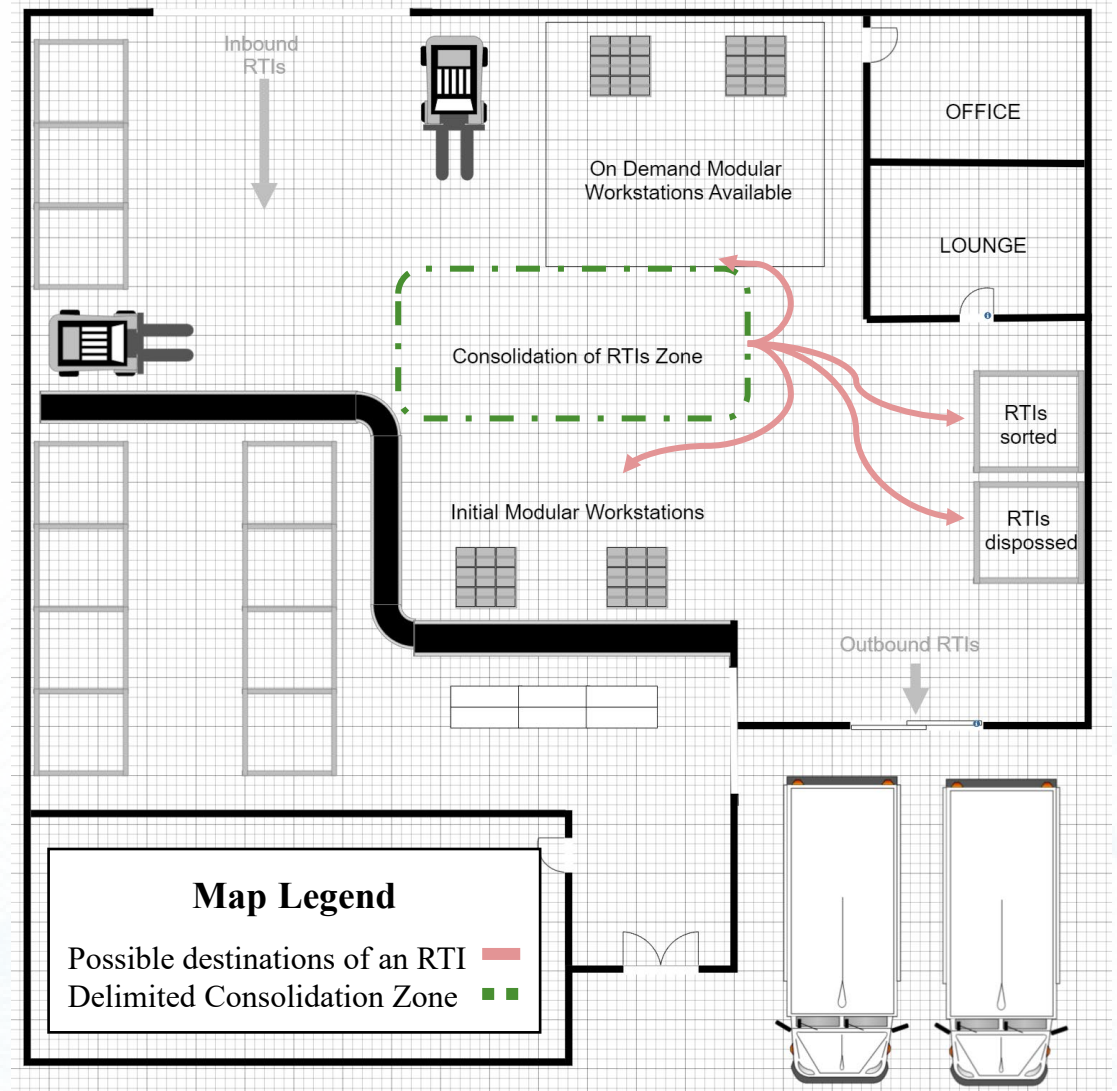

Simulation Results

Demand Repairs Forecast vs Performance of the Maturity Models (Smaller Size Layout)

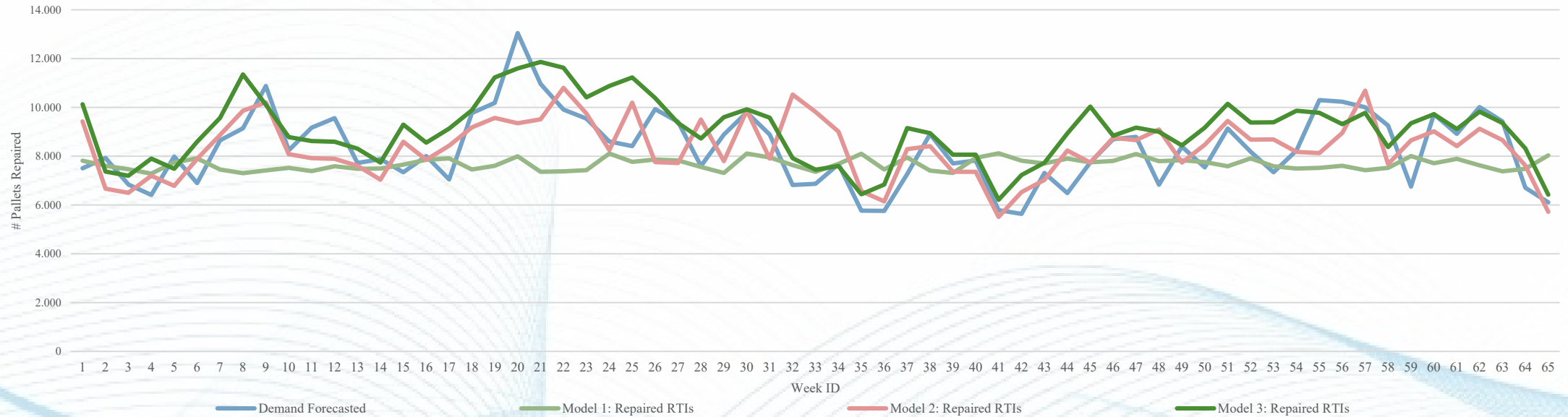

Comparisson of Cycle Times per Maturity Level (Small Layout)

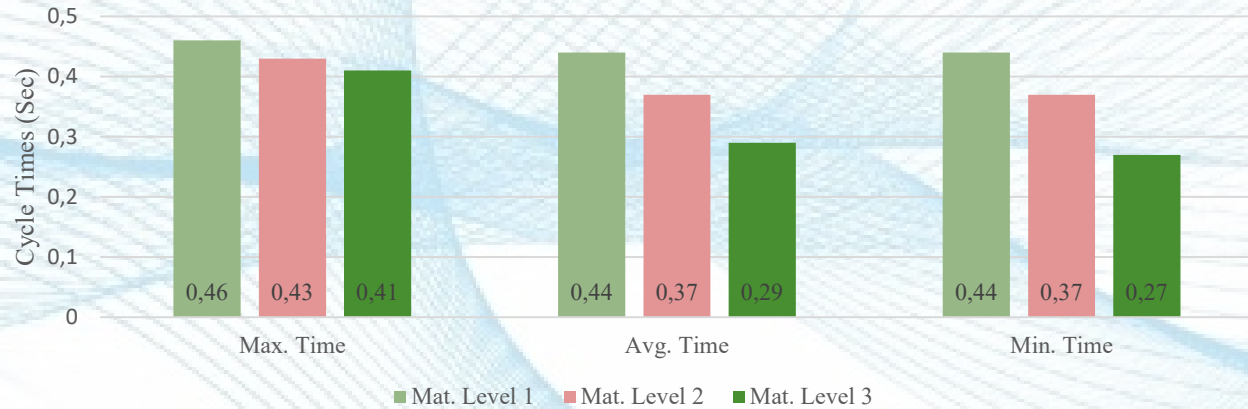

Simulation Results

Demand Repairs Forecast vs Performance of the Maturity Models (Larger Size Layout)

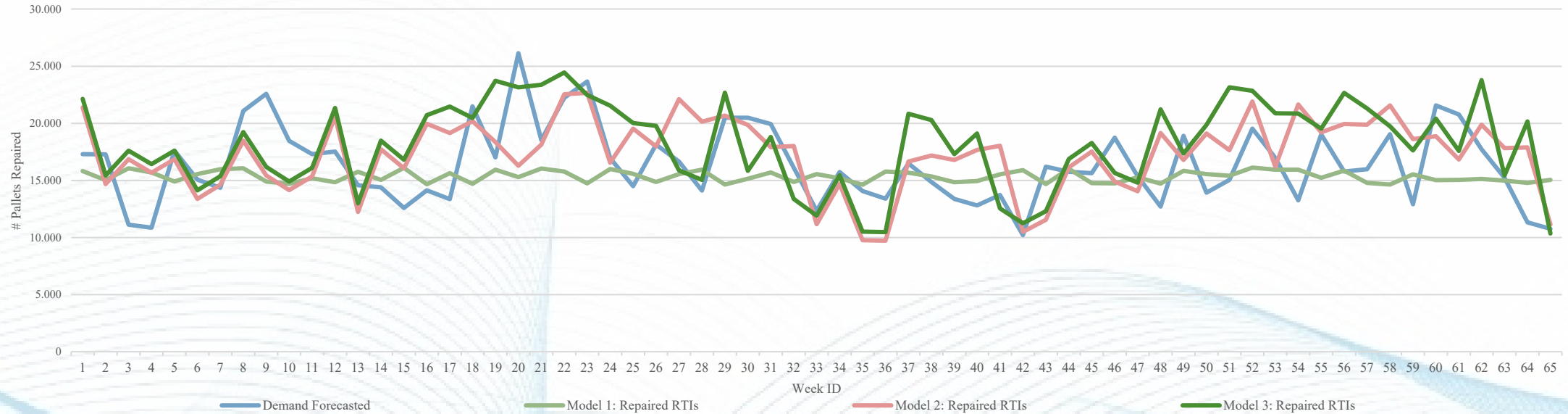

Comparison of Cycle Times per Maturity Level (Large Layout)

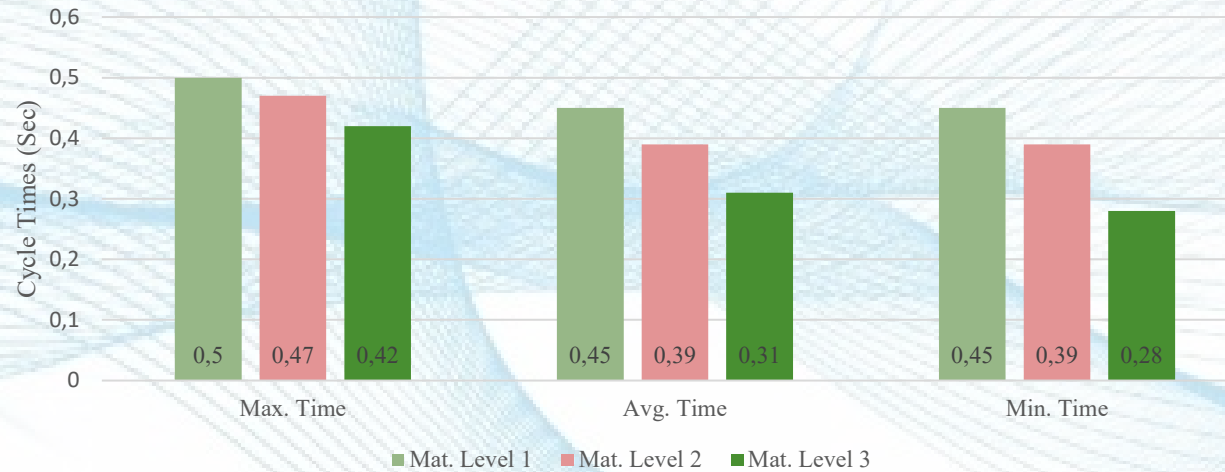

Simulation Results

RTI availability vs Performance of the Models (Smaller Size Layout)



RTI availability vs Performance of the Models (Larger Size Layout)

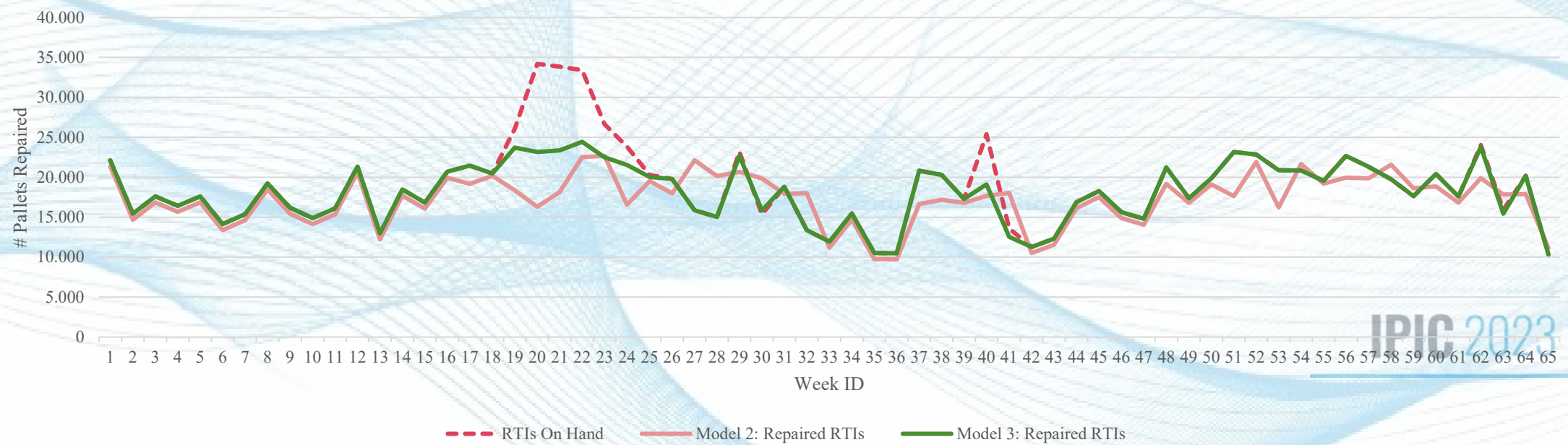

Conclusion

When faced with variable demand and the need for prompt management of this variability, PI offer significant competitive advantages.

Modularity offers the freedom to adapt production levels in accordance with fluctuations in demand, mitigating the risks associated with shortages and overproduction.

Modularity significantly reduces dependencies on inventory levels of finished Returnable Transport Items (RTIs), leading to a substantial reduction in holding costs.

Modularity significantly enhances the capability to convert available inventory into finished products that are ready for dispatch.

Cargo consolidation greatly enhances the capacity to consolidate Returnable Transport Items (RTIs) in advance, resulting in expedited shipments to customers.

Cargo consolidation shifts the primary constraint within the system from capacity to the availability of incoming materials.

References

- Babalou S., W. Bao, B. Montreuil, L. McGinnis, S. Buckley, A. Barenji (2021): Modular and Mobile Design of Hyperconnected Parcel Logistic Hub. Proceedings of IPIC 2021 International Physical Internet Conference.
- Gnoni M., V. Elia. (2015): Designing an effective closed loop system for pallet management, International Journal of Production Economics, vol. 170, pp. 730-740.
- Montreuil B. (2011): Towards a Physical Internet: Meeting the Global Logistics Sustainability Grand Challenge, Logistics Research, Vols. 3, no. 2-3, pp. 71-87.
- Montreuil B., E. Ballot, W. Tremblay. (2015): Modular Design of Physical Internet Transport, Handling and Packaging Containers, Progress in Material Handling Research, vol. 13.
- Sallez Y., S. Pan, B. Montreuil, T. Berger, E. Ballot (2016): On the activeness of intelligent Physical Internet containers, Computers in Industry, vol. 81, pp. 96-104.



Thanks !

For questions and comments please reach me to:
jgarcia341@gatech.edu

IPIC 2023

9th International
Physical Internet Conference

June 13-15, 2023
Athens, Greece

13-15 JUNE 2023 Athens, Greece
www.pi.events/IPIC2023

alice | Alliance for
Logistics Innovation
through Collaboration
in Europe



Expanding the logistics Scope



Additional Information

KPI's	MLs	Max. Value	Average Value	Min Value
1. Number of pallets repaired per week (Smaller Layout)	Level 1	8,120	7,710	7,281
	Level 2	11,388	9,051	6,215
	Level 3	12,294	9,051	6,215
2. Number of pallets repaired per week (Larger Layout)	Level 1	16,010	14,298	13,440
	Level 2	22,472	18,154	10,353
	Level 3	24,638	18,154	10,353
3. Inventory on Hand Utilization (Smaller Layout)	Level 1	95.21%	63.06%	52.79%
	Level 2	97.68%	92.93%	88.83%
	Level 3	99.63%	99.38%	99.17%
4. Inventory on Hand Utilization (Larger Layout)	Level 1	92.01%	59.66%	49.31%
	Level 2	96.14%	91.88%	85.59%
	Level 3	98.77%	98.57%	98.25%

RTI availability vs Maximum Capacity (Smaller Size Layout)

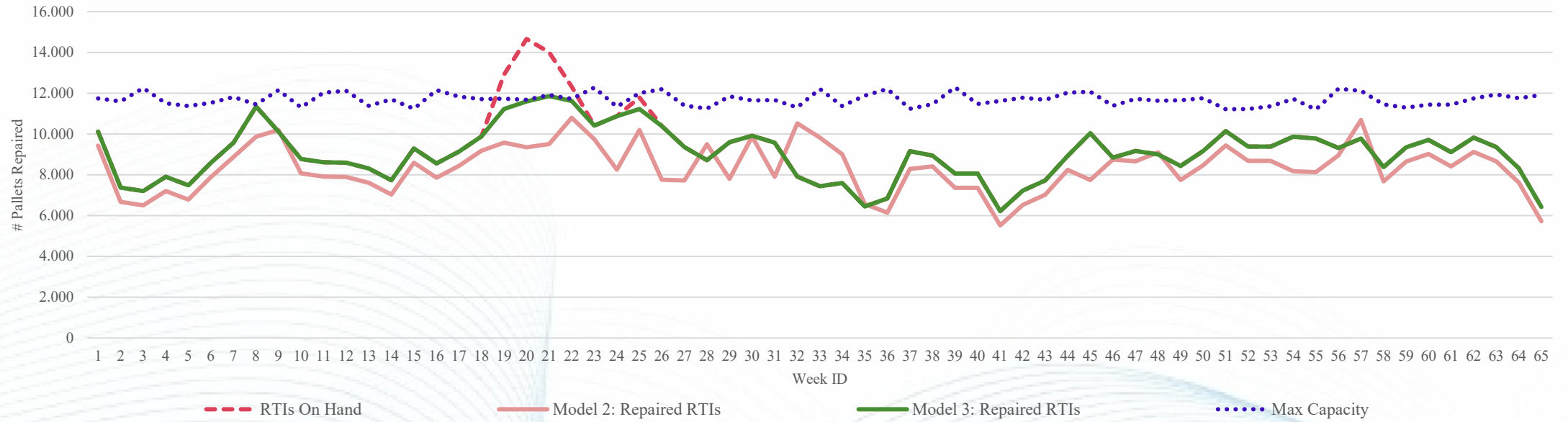

RTI availability vs Maximum Capacity (Larger Size Layout)

